

WHITE
MOUNTAIN
IMAGING



2009 PRODUCT CATALOGUE



PRODUCT CATEGORY	PRODUCT	PAGE NO.
Quality Control Supplies	Portable S.G. Test Kit	2
	Hypo Estimator Test Kit	2
	DFP-450 Thermometer	3
	TM-99A Digital Thermometer	3
	Silver Test Paper	3
	pH Test Papers	4
	Roller Clean	4
	Screen Cleaner	4
Processor Filters	Developer Filter	5
	“SlimLine” Developer Filter	5
	Konica Filters	5
	Hot/Cold Water Filter	6
	Clear Water Filter Housing	6
Processor Maintenance Supplies	Gorman-Rupp Replenisher Pump	7
	Gorman-Rupp Pocket Bellows Pump	7
	March MDX3 Recirculation Pump	8
	March 802 Recirculation/Replenisher Pump	8
	March 802 RA 5000 Recirculation/Replenisher Pump	8
Pollution Abatement Devices	Accu-Tech® Pollution Control Systems for Silver Recovery	9
	Silver Trap	10
	Phase One Fixer Treatment Cartridges	11
	Final Phase Treatment System	12
	EPAN Chamber	12
Cleaning Supplies	Neutra•Sol™ X-Ray/Photo Processor Drain Cleaner	13
	Fotex Drain Cleaner	14
	Clear Image Cleaning Solution	14
	Photobrome™ Lab Pak II	15
	Photobrome™ Tablets	15
	Photobrome™ Feeder	15
	Scotch-Brite® Scrubbing Sponges	16
	Scotch-Brite® Cleaning Pads	16
Darkroom Supplies	Adzorbstar® Molecular Adsorber Disposable Air Cleaners	17
	Silvermax Splicing Tape	17
	Spill Bloc™ Spill Response Polymer Kit	18
	Spill Control Response Kit	18
	IS-199 Chemical Mixer	19
IS-199 Chemical Mixer	Technical Specifications	20
	Replacement Parts Diagram	21
	Replacement Parts	22
	Chemical Mixer Conversion Kits	23
Accessory Chemicals	T2 Developer Activator	23
	T2 Developer Starter	23
	SR2 Developer Systems Cleaner	24
	T2 ESC Developer Cleaner	24
	T2 Fixer System Cleaner	24
Ordering Information	General Ordering Information	25
	Listing by Part No.	26
Index	Fax Order Forms	27, 28
	Brochure/MSDS Fax Order Form	29



New Hampshire Maple Syrup

Many of you know that for years we have been giving away small tins of maple syrup at the RSNA and other Trade Shows as a way of giving our customers a small taste of the region we come from.

Over the years these have become quite popular. So, in response to the many requests we received, we have begun carrying them in our inventory. It's fun to help provide our customers with a taste of something that is so uniquely New England.

The Maple Syrup Process

Maple syrup is made from the sap of maple trees. In early spring when the temperature is above 40 degrees during the day and below 32 degrees at night, the sap begins to run from the roots to the branches of the maple trees. Approximately 40 gallons of sap are boiled down to produce just 1 gallon of syrup. State Inspectors assist producers to maintain the highest quality product and service. Remember that all syrup should be kept in your refrigerator or freezer to assure the highest flavor retention.

The Sugar Shack
Barrington, NH 03825

Catalogue # NHMAPLE 16.9 FL. OZ.
Price: \$11.50



Portable S.G. Test Kit (with thermometer)

A lightweight test kit for on-site chemical testing. This kit contains all the necessary tools to check specific gravity and solution temperature.

The S.G./Temperature Portable Test Kit includes:

- Foam Filled Lightweight Case
- Graduated Plastic Cylinder, 250ml
- Glass Hydrometer, 1.00 - 1.200
- DFP-450 Thermometer

Catalogue #3517-P

List Price: \$167.50

Hydrometer:

Catalogue #3518

List Price: \$61.50

Cylinder:

Catalogue #3516

List Price: \$66.25

Plastic Cylinder:

Catalogue #3516-P

List Price: \$50.00



Catalogue #3517-P

WMI Hypo Estimator Test Kit

ACR guidelines recommend that mammographic films be checked for hypo retention on a quarterly basis. This test is also useful for assuring the archival stability of any radiographic film.

- Provides quick visual readings of estimated Hypo (Thiosulfate)
- Complete kit includes: Test Solution; Estimator Chart; Storage Kit

Catalogue #3564

List Price: \$32.60

Unique Color Chart

Allows comparison with all color blocks simultaneously, saving time and eliminating errors.

Catalogue #3564-CHT

List Price: \$8.95

Test Solution

Catalogue #3564-SOL

List Price: \$14.95



Catalogue #3564



DFP-450 Thermometer

This popular digital thermometer has been improved with several significant new features. Unit shuts itself off if not used for a period of 50 minutes, extending battery life. It features a dual purpose activate/update button. When pressed once and released, unit will turn on and update every 10 seconds. When button is pressed and held, unit will provide a continuous update of the read-out. For higher temperature applications, the DFP-450 has a service range of -40° to 450°F. The "flat head" case design makes pocket carrying convenient and prevents damage from rolling off counter tops.

Catalogue #3555

List Price: \$44.64



Catalogue #3555

BROCHURE AVAILABLE

TM-99A Digital Thermometer

The economical Electro-therm Model TM-99A Thermistor-based digital thermometer is portable, lightweight, and offers a wide temperature range of -40° to +450°F (-40° to +100°C) with 0.1°F resolution and a system accuracy of ±0.2°F or ±0.2% of reading. LCD displays both °F and °C.

It comes complete with 9 volt alkaline battery, detachable 10K Thermistor Probe* and shock resistant plastic case. Includes Calibration Plug** to insure continued accuracy.

Case size: 9½" x 6½" x 2½"

Catalogue #3558

List Price: \$181.25

BROCHURE AVAILABLE



Catalogue #3558

Probe (sold separately)

* **Catalogue #3558-P**

List Price: \$50.00

** **Calibration Plug (sold separately)**

Catalogue #3558-CAL

List Price: \$13.35



Catalogue #3519

Silver Test Paper

German made silver test paper in convenient roll form. Color coded scale reads out in both Troy ounces per gallon and gram per liter.

Catalogue #3519

List Price: \$53.00

QUALITY
CONTROL
SUPPLIES



RollerClean

For all automatic processors. RollerClean safely and economically keeps processor rollers and racks free from silver and chemical buildup. There's no need to remove the processor racks. Use daily to maintain optimum conditions. May be used more than once without fear of developer contamination.

Catalogue # WM-RC1417 (50-14" x 17" sheets per box)

List Price: \$77.65



Catalogue WM-RC1417

Kyokko Screen Cleaner

Kyokko Screen Cleaner with anti-static is recommended for use on intensifying screens.

Catalogue # WM-SCLR500-Case (4 x 470mL bottles)

List Price: \$64.95



Catalogue #WM-SCLR500

pH Test Papers

A simple and inexpensive tool for locating possible quality control problems such as improper mixing or chemical contamination.

Catalogue #3524 – Developer pH Range: 9.2-10.6

Catalogue #3525 – Fixer pH Range: 3.0-5.5

List Price: \$10.10/roll



Catalogue #3524 & #3525





* Catalogue #3570

Developer Filter, 2½" x 4¾"

For use in the following processors:

M5, M6, M6N, M6AW, M6B, M7A, M7B, M8, M20, M35, RA480 and Alpha Tech

Sold in case lots – 60 filters per case.

Micron Rating: 70µ

* Catalogue #3570

List Price: \$ 9.44 each

"SlimLine" Polypropylene Developer Filters for RA and LP Processors

Use in LP180 n RA270 Processors

- Exact replacement for original filter
- High efficiency
- Long Life

Sold in case lots – 24 filters per case.

Micron Rating: 70µ 1¾" x 538"

* Catalogue #3574

List Price: \$17.25 each

* Filters may be combined for quantity discounts



* Catalogue #3574

BROCHURE AVAILABLE

* Filters may be combined for quantity discounts



Catalogue #3575

Konica Developer Filters

For use in a Konica 501 Processor.

30 filters per case.

Micron Rating 25µ

Catalogue #3575

List Price: \$132.66

PROCESSOR
FILTERS



Hot/Cold Water Filter,

2½" x 9¾"

- Effectively removes dirt, rust and scale from hot or cold water feed lines.
- Fits Cuno, Teel, Pako, Alpha Tech and many other filter housings.

Sold in case lots – 30 filters per case.

* Catalogue #3571 Micron Rating: 20-30µ

List Price: \$12.38 each



*Catalogue #3571 & #3572

Filters may be combined for quantity discounts

* Catalogue #3572 Micron Rating: 5-10µ

List Price: \$12.54 each

12" Water Filter

(24 per Case)

Fits 3M Laser Processor

* Catalogue #3573 Micron Rating: 20-30µ

List Price: \$14.50 each

Water Filter Housing

- Heavy Duty Construction
- Anti-Seize Threads
- Leak-Free Design
- Clear Housing
- Uses 9 7/8" Filter Cartridges
- Rated Up To 150°F
- Bracket not included, sold separately

Catalogue #3579

List Price: \$76.75



Catalogue #3579

Mounting Bracket

Not included with housing, must be purchased separately.

Catalogue #3580

List Price: \$11.75

Filter Wrench

Catalogue #3579-W

List Price: \$12.40

Replacement "O" Ring

Catalogue #3579-O

List Price: \$4.15



Gorman-Rupp Pocket Bellows Pump

- 240 Volt
- 72 RPM
- 1 ½" pocket bellows

This pump fits the following processors:

- Eastman Kodak LP 180
- Eastman Kodak 270RA
- Eastman Kodak 3000RA

Catalogue #3559 – 240 volt

List Price: \$450.00



Catalogue #3559

Gorman-Rupp Replenisher Pump

- Positive Displacement
- Self Priming
- Updated in 1996, this pump has improved chemical resistance

Available in both 115 volt and 240 volt configurations. New compact design allows a greater variety of replacement applications including:

Catalogue #3560 – 240 volt

List Price: \$499.25



Catalogue #3560 – 240 volt

Catalogue #3560-115 – 115 volt

Fits the following processors:

- Eastman Kodak – M6N
- Eastman Kodak – M6AN
- Eastman Kodak – M6AW
- Eastman Kodak – M6B
- Eastman Kodak – M8
- Eastman Kodak – M20 - Model 2
- Eastman Kodak – M35, M35M
- AFP 14825 – 540

Catalogue #3560-115 – 115 volt

- Eastman Kodak – M35A & M35AM
- Alphatek 700 LE

List Price: \$499.16

Gorman-Rupp Replenisher Pump for M7-B

Includes mounting pad, ss hold-down screws, and electrical connectors.

Catalogue #3560-M7-115

List Price: \$1183.42





Catalogue #3562

March MDX3 Recirculation Pump

- Magnetic Drive
- 316 Stainless Hardware
- 5/8" Inlet/Outlet Ports
- 115 Volt

For use in Eastman Kodak M7 processors and other 115 volt applications.

Catalogue #3562

List Price: \$427.75

Recirculation/ Replenisher Pump

- Magnetic Drive
- 316 Stainless Hardware
- 5/8" Inlet/Outlet Ports
- 230 Volt

Fits the following processors:

- Eastman Kodak – M6N
- Eastman Kodak – M6AN
- Eastman Kodak – M6AW
- Eastman Kodak – M6B
- Eastman Kodak – M20-Model 2
- Eastman Kodak – 2000

Catalogue #3561

List Price: \$686.25



Catalogue #3561

March 802 Recirculation Pump

- 115 Volt
- Fits Eastman Kodak – M35A, M35AM & 2000A

Catalogue #3561-115

List Price: \$617.75

March 802 RA 5000 Recirculation Pump

- Fits Eastman Kodak – RA 5000

Catalogue #3561-RA 5000

List Price: \$679.25



ACCU-TECH® Pollution Control Systems for Silver Recovery

ACCU-TECH® has developed a logical approach to pollution control for silver recovery.

The systems work on the galvanic reaction principle whereby an electrical charge is produced chemically, plating high-grade silver onto replaceable recovery cells.

ACCU-TECH® systems, designed for maximum EPA efficiency, can also be used as an ideal tailing system to bring existing electrolytic units into EPA compliance.



ACT I™

(2-15 gallons/mo.)
Capacity:
150 Gallons or
12 Months

Catalogue #3607

List Price: \$308.00

TANDEM 100™

(15-35 gallons/mo.)
Capacity: 70 Troy Ounces or
2,174 Grams
200-300 Gallons

Catalogue #3605

List Price: \$536.00

TANDEM 200®

(35+ gallons/mo.)
Capacity: 90 Troy Ounces or
2,799 Grams
350-450 Gallons

Catalogue #3600

List Price: \$714.25

Replacement Cells

2 per box

Catalogue #3601

List Price: \$124.25

Replacement Cells

2 per box

Catalogue #3606

List Price: \$108.25

Replacement Cells

2 per box

Catalogue #3601

List Price: \$124.25

DESCRIPTION	ACT I™			TANDEM 100™			TANDEM 200®		
GALLONS/MO.	2-15			15-35			35+		
SUGGESTED PLATING CAP.	38 Troy Ounces or 1,180 Grams			70 Troy Ounces or 2,174 Grams			90 Troy Ounces or 2,799 Grams		
SILVER CONTENT T.O./GALLONS	TOTAL GALLONS	SILVER CONTENT GM/LITER	TOTAL LITERS	TOTAL GALLONS	SILVER CONTENT GM/LITER	TOTAL LITERS	TOTAL GALLONS	SILVER CONTENT GM/LITER	TOTAL LITERS
1/8	150	1.00	568	560	1.00	2120	720	1.00	2730
1/4	150	2.05	568	280	2.05	1060	360	2.05	1365
1/3	110	2.71	415	210	2.71	795	270	2.71	1033
MAXIMUM FLOW RATE	125 ml/min.			125 ml/min.			125 ml/min.		
OVERALL DIMENSIONS	12"W x 12"D x 13.125"H			17"W x 11"D x 13"H			19"W x 13"D x 15"H		

POLLUTION
ABATEMENT
DEVICES



Silver Trap Windows

- Clean, safe and fast replacement
- Heavy duty iron-matrix screen core
- Unique clear plastic see-thru design
- Integral cell and shipping jar in one
- Ideal for all fixers

The silver-filled exhausted window unit can be easily replaced in a few minutes. The silver trap unit has a unique plastic housing for optimum monitoring and visual observation. When drained of the liquid, the used plastic cell housing becomes a convenient airtight shipping container. The unit can also be easily rinsed to meet EPA shipping regulations. The silver-laden used cell can then be sent to refining inside the reusable cardboard box that made up its original package.



Catalogue #3611



Catalogue #3612

Catalogue #3630-36 Silver Trap Window 36 Gallons

List Price: \$307.25

Catalogue #3612 Silver Trap Window Compact

List Price: \$80.99

Catalogue #3612-R Replacement Cells

List Price: \$54.70

Catalogue #3611 Silver Trap Window

List Price: \$98.50

Catalogue #3611-R Replacement Cells

List Price: \$65.75

Catalogue #3614 Silver Trap Window Wrench

List Price: \$26.25

Catalogue #3613 Silver Trap Wall Mount Bracket

List Price: \$38.25

INSTALLATION	MODEL #	SINGLE CELL	TANDEM CELLS	3 CELL SERIES
SILVER CAPACITY	ST-WD ST-WDC	100 Troy Oz * 50 Troy Oz *	200 Troy Oz * 100 Troy Oz *	300 Troy Oz * 150 Troy Oz *
VOLUME CAPACITY				
Primary Use	ST-WD ST-WDC	300 gal (1,136 liters) 150 gal (568 liters)	500 gal (1,893 liters) 250 gal (947 liters)	700 gal (1,850 liters) 350 gal (1,325 liters)
Electrolytic Back-up Use	ST-WD ST-WDC	1,000 gal (3,785 liters) 500 gal (1,893 liters)	1,500 gal (5,678 liters) 500 gal (1,893 liters)	2,000 gal (1,850 liters) 700 gal (1,850 liters)
MAXIMUM FLOW RATE				
Both primary and electrolytic backup use	ST-WD ST-WDC	0.8 GPH (3.0 liters/hr) 0.4 GPH (1.5 liters/hr)	1.6 GPH (6 liters/hr) 0.8 GPH (3 liters/hr)	2.4 GPH (9 liters/hr) 1.2 GPH (4.5 liters/hr)
	ST-WD ST-WDC	100 ml/min (intermittent) 50 ml/min (intermittent)	200 ml/min (intermittent) 100 ml/min (intermittent)	300 ml/min (intermittent) 150 ml/min (intermittent)





Phase One Fixer Treatment Cartridges

Provides inexpensive, reliable initial desilvering of x-ray fixers. When properly installed they will eliminate the risk of “channeling” or leaking. PHASE ONE CARTRIDGES are an effective first step in achieving EPA compliance for effluent discharge. Available in 3 and 5 gallon capacities.

CAT. #	LIST PRICE
#3630-3	\$86.75
#3630-5	\$119.25

Catalogue #3630-3 (3 gal. capacity)

Specifications

DESCRIPTION	CAT. 3630-3	CAT. 3630-5
VOLUME	3.5 Gallons	5 Gallons
MEDIA WEIGHT	4 lbs.	8 lbs.
CAPACITY FIXER	120 Gallons	240 Gallons
MAXIMUM LIFE*	9 Months*	9 Months*
MAXIMUM FLOW RATE*	100 ml per minute*	100 ml per minute*
DIMENSIONS	12.0”D x 11.5”H	12.0”D x 15.0”H
PORT HEIGHT	9.0”	12.25”
SHIP WEIGHT	7 lbs.	13 lbs.
POSITION OUTLET	90 Degrees	90 Degrees
TYPE	Steel Wool	Steel Wool
FITTINGS	3/4” Hose	3/4” Hose

* Flow rate and life of the cartridge is dependent upon the type of fixer and pH of the fixer.



Final Phase Treatment System

Treats 1000 gals of Combined Developer & Fixer

The FINAL PHASE TREATMENT SYSTEM completes the process of effluent treatment prior to final discharge. When used in conjunction with a metallic replacement recovery device, such as Phase One, the Final Phase ensures EPA compliance for pH, BOD-5, COD, suspended solids, iron and silver discharge.

Final Phase Provides:

- pH neutralization of waste developer and fixer
- Reduced maintenance of drains by filtering out suspended solids and sacrificial iron released in the development and silver recovery process
- Reduced BOD-5 & COD Levels
- Single point sampling of process or discharge
- Final desilvering of developer, fixer and wash water (Final Phase must be used downstream of metallic exchange type recovery device in order to provide desilvering function)

BROCHURE AVAILABLE

Specifications

Diameter 12"
 Total Height 15"
 Inlet Height 12 1/2"
 Outlet Height 7"
 Fittings 3/4" Hose
 Capacity 1000 Gallons
 Flow Rate 1 1/2 GPM



Catalogue #3618

Catalogue # 3618

List Price: \$198.50



Catalogue #3620

BROCHURE AVAILABLE

EPAN Chamber

- No electricity required.
- Pre-treatment device for graphic and x-ray photo processor and silver recovery effluent.
- Removes sediment before it enters the drain.
- Reduces darkroom drain blockages.
- Reduces drain deterioration from chemical precipitation and reaction.
- Dilutes and neutralizes system discharges.
- Easily pays for itself many times over.

- Further reduces silver discharge levels to help meet EPA requirements.
- The final solution for your processor drain problems.
- Height: 11" for 3.5 gal. & 19" for 6.5 gal.

Catalogue #3620

3.5 Gallon EPAN Chamber

Catalogue #3621

6.5 Gallon EPAN Chamber

List Price: \$289.25



Catalogue #3625

EPAN Installation Kit

(sold separately)

Includes hose, clamps, adapters and elbows to facilitate hook-up to virtually any film processor.

Catalogue #3625

List Price: \$59.25



Neutra•Sol™ X-Ray/Photo Processor Drain Cleaner

- Convenient, easy to use
- Specially formulated to dissolve calcium carbonate and iron deposits
- Safe for use with plastic and iron drain pipes
- Meets UN and D.O.T. standards as a non-corrosive substance
- Packaged: 11 x 16 Fl. oz.



Catalogue #3511

Chemical build-up in floor drains of film processing equipment is generally caused by calcium carbonate from developer overflow and from iron deposits from steel wool silver recovery. Dissolving these materials after solid build-up has occurred is a difficult task. The general consensus within the industry is that preventative measures should be taken to prevent or retard the inevitable build-up that is likely to occur. Liquid cleaners currently used for this purpose tend to be corrosive and dangerous to handle, or not very effective. Powdered cleaners tend to be messy and the dust from these powders can be inhaled, if proper preventative measures are not taken. Additionally, typical commercial household drain cleaners tend not to be effective at all, due to their alkaline formulation.

Neutra•Sol™ Liquid Drain Cleaner has been specifically formulated to attack calcium carbonate and iron deposits found in the typical, film/photo processor drain. Neutra•Sol™ Liquid Drain Cleaner is at the same time non-corrosive to steel.

Neutra•Sol™ Liquid Drain Cleaner formulated as a liquid for ease of use and handling – and used as recommended – is designed to assist in preventing excess build-up in processor floor drains, and is packaged in 16 fluid ounce bottles.

Neutra•Sol™ Drain Cleaner

Catalogue #3511

List Price: \$30.50

Packaging: 1 Case contains 11 x 16 oz. bottles

BROCHURE AVAILABLE

CLEANING
SUPPLIES



Fotex Drain Cleaner

- Dissolves and removes chemical deposits that organic cleaners can't budge.
- Eliminates drain repair and replacement.
- Reduces costly downtime.
- Eliminates flooding and shock hazards due to drain back-up.

Catalogue #3515

List Price: \$116.75

Fotex Drain Cleaner is especially compounded to react with and dissolve chemical residue deposits commonly found in photographic and x-ray processor drains.

Ordinary drain cleaners are designed to dissolve foreign matter accumulated in drain traps. This foreign matter must be organic in nature in order for most commercial drain cleaners to be effective. Ordinary drain cleaners will, therefore, not effectively remove chemical deposits. Chemical residue deposits found in processor drains gradually build up along the entire inside surface area of the drain pipe. Inevitably these deposits will completely restrict the flow of effluent through them, causing drain backup and resulting in



Catalogue #3515 36 packets per case

flooding conditions. When the drains reach this restricted condition, they must often be replaced or mechanically cleaned out, if possible.

Fotex Drain Cleaner will dissolve these deposits, but severely restricted drains may require initial mechanical cleaning. Fotex Drain Cleaner is an extremely efficient preventative maintenance product. Regular and consistent use will discourage the chemical deposits from accumulating within the drain system.

When initially using Fotex, it will be beneficial to use more than the recommended amount, more frequently, to help remove previously deposited material from the drain systems.

BROCHURE AVAILABLE

Clear Image

Working Solution for Cleaning Radiological Equipment

Clear Image Radiographic Cleaner used for cleaning film processors, silver recovery units and chemical mixers and general darkroom uses.

- Cleans viewboxes
- Cleans fixer, developer and wash tanks
- Cleans fixer & developer spills
- Cleans roller systems
- Cleans the processor recirculation system



Catalogue #3684

Catalogue #3684 Clear Image (32oz. bottle)

List Price: \$25.42

Catalogue #3685 Clear Image (12 x 32oz. bottles)

List Price: \$269.10

Catalogue #3686 Clear Image (4 x 1 gal.)

List Price: \$265.00



Photobrome™ Lab Pak II

- May be used in manual tanks or directly in processor wash tanks.

Photobrome™ is a bromine-based sanitizer used for controlling microbiological growth in photo-processing wash waters. It may be added to your water supply line by means of a Photobrome™ Feeder, or, for convenience, place Lab Paks directly in the wash tank.



Catalogue #3509 **BROCHURE AVAILABLE**

Although Photobrome™ is not intended to remove existing biological growth, it significantly reduces algae buildup so that there is less to clean and cleaning does not need to take as long. It is important to clean the processor thoroughly prior to using Photobrome™.

Photobrome™ also reduces residual thiosulfate levels, thereby improving a film's archival quality.

Catalogue #3509 - Box (6 packs per box)

List Price: \$32.89

Catalogue #3510 - Case (8 boxes per case)

List Price: \$202.00

Photobrome™ Tablets

For use with Photobrome™ Feeder.

- * Catalogue #3507 - 5 lb. Wide Mouth Bottle

List Price: \$60.25

- * Catalogue #3508 - 4 x 5 lb. Wide Mouth Bottles

List Price: \$189.75 (Case)

- * 3 cases or less will be subject to current UPS hazardous charges. WMI will absorb these charges with your order of 4 cases or more.

- ** Subject to change.

BROCHURE AVAILABLE



Catalogue #3507



Catalogue #3504

Catalogue #3504

List Price: \$163.15

Feeder Basket

Includes Screen Sock
Catalogue #3504-B

Feeder O-Ring

Catalogue #3505

Feeder Cap

Catalogue #3506

Photobrome™ Feeder

A convenient and economical device for introducing metered amounts of Photobrome™ into the wash water. Feeder includes Bromine test kit and installation fittings.

BROCHURE AVAILABLE

CLEANING
SUPPLIES



Scotch-Brite® Scrubbing Sponges

3M's Scotch-Brite® on one side – an absorbent sponge on the other side.

Catalogue #3532-SP - Case

List Price: \$61.00

Packaging: 20 sponges per case



Catalogue #3532-SP

Scotch-Brite® Cleaning Pads

The ideal product for cleaning rollers and processing tanks.

Catalogue #3512 - Box

List Price: \$35.40

Catalogue #3513 - Case

Packaging: 20 sheets per box. 3 boxes per case.



Catalogue #3513

Ultra Fine Cleaning Pads

Catalogue #3529-UF - Box

List Price: \$35.40

Catalogue #3530-UF - Case



Adzorbstar®

Molecular Adsorber Disposable Air Cleaners

- Eliminates Odors, Gases and Fumes
- Reduce Potential Liabilities
- Complies with OSHA Standards
- Create a Safer Environment
- Improve Indoor Air Quality
- Help Increase Productivity
- Lasts for Up to Six Months
- Requires No External Power
- Emits No Masking Scents
- Permits Safe Legal Disposal
- Eliminates Mildew Growth

A patented technology, the Adzorbstar® Molecular Adsorber requires no external power, is non-toxic, non-hazardous and biodegradable. The unit's visual clue of effectiveness is sodium cobalt chloride crystals. Blue pellets turn pink, indicating unit needs a refill change lasting approximately six months. The patented metal core extends the beige pellets active life. The plastic caps are used to adjust cleansing effects. Remove caps for maximum exposure. Active ingredient: synthetic sodium aluminosilcate.



Packaging: 12 Units per Case

*Items may be combined for quantity discounts

BROCHURE AVAILABLE

CAT. #	DESCRIPTION	LIST PRICE
#3651	32 oz. Adzorbstar Unit w/Bracket	\$73.50
#3652	16 oz. Adzorbstar Unit w/Bracket	\$41.99
#3653	32 oz. Adzorbstar Refill Canister	\$50.40
#3654	16 oz. Adzorbstar Refill Canister	\$27.85



Catalogue #3553

Silvermax Splicing Tape

A metallized polyester film, silver pressure sensitive acrylic adhesive system with a total thickness 2.2 mils. Designed as a splicing tape for x-ray films.

Catalogue #3551 – 1" Silvermax Tape

List Price: \$30.85

Catalogue #3553 – 1/2" or 1" Dispenser

List Price: \$33.75



Spill Bloc™ Spill Response Polymer Kit

Turn photographic chemical spills into a non-hazardous, non-toxic solid in seconds!

- 2 bottles of Spill Bloc granules
- Nitrile gloves & apron
- Chemical splash goggles
- Whisk set & plastic disposable bags
- Wall mount unit with hardware
- Instructions on side of bottle

Sized for minilabs, pre-press and X-ray processing facilities, Spill Bloc contains everything needed to clean up a spill safely, efficiently, and legally. Each bottle of Spill Bloc absorbs up to 5 gallons of liquid. The major component of Spill Bloc is a non-biodegradable copolymer, which forms extremely stable silver polymer complexes. Spill Bloc treated chemicals are reduced to below the regulated limits using the U.S. Toxicity Characteristic Leachate Procedure (TCLP). The granules are safe to handle and are not regulated by WHMIS (Canada) or OSHA (USA).



Catalogue #3642

Catalogue #3642

List Price: \$83.65

Catalogue #3642-R

List Price: \$37.20

Spill Control Response Kit

Spill clean-up materials are often required for emergency response plans since local sewer use restrictions generally prohibit spilled photographic chemicals from being discharged to sewers. SPILL CONTROL RESPONSE KIT provides an economical and convenient method for containing and clean-up of chemical spills. Spill Control contains 3M Powersorb™ absorbent materials. Powersorb™ sorbents are specially treated, chemically inert polypropylene microfibrils which absorb up to 18 times their own weight.

Spill Control Response Kit contains:

- Tyvek apron & shoe coverings
- Nitrile gloves
- Eye protection goggles
- 3M Powersorb mini-booms
- 3M Powersorb pads
- 3M Powersorb Superfold
- Workplace & shipping labels
- Approved shipping container with gasket seal lid for transportation & removal



Catalogue #3641

Catalogue #3641

List Price: \$95.50

BROCHURE AVAILABLE





Standard 12.5 Gallon Capacity

Dimensions: 30" H x 24" W x 12" D

Spill Tray

The IS-199 Spill Tray conveniently fits under the IS-199 Chemical Mixer to provide *secondary containment* for potential leaks or spills.

26" L x 18" W x 5" H

Catalogue #1923

List Price: \$50.00

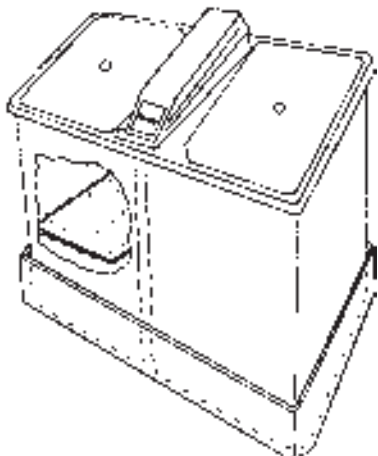

IS-199

Versatile Chemical Mixer for use with:

- X-ray
- Graphic Arts
- Photo Products
- One Year Warranty on all Parts

BROCHURE AVAILABLE



Space Saver 7.5 Gallon Capacity

Dimensions: 21" H x 24" W x 12" D

Floating Lid

The IS-199 Floating Lid is designed to extend developer life by reducing aerial oxidation. The IS-199 Floating Lid is especially useful in low volume situations where premature oxidation may occur.

Catalogue #1924

List Price: \$22.50

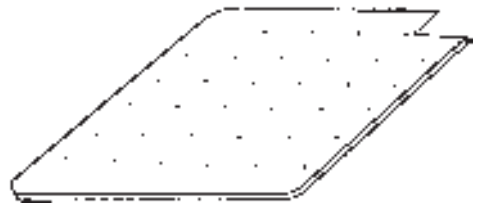

BROCHURE AVAILABLE

IS-199
CHEMICAL
MIXER



Technical Specifications

The IS-199 incorporates a unique combination of features which make it the Mixer of Choice for both the user and the serviceman.

The Specific Gravity Mixing System allows the user to start a mix anytime. The mixer responds to the addition of concentrated chemicals and adds the correct amount of water automatically.

Features

- Specific Gravity Mixing System – The Ultimate in Convenience and Accuracy
- Rugged Field Tested Components Assure Reliability
- 24 Volt Operation – Uses NO Circuit Boards
- Audible and Visible Low Level Warning Systems
- Easy-to-Service Design
- UL/CSA Approved External Power Supply

All Electronic Components have been chosen for dependability. Straight-forward circuit designs eliminate the need for circuit boards thereby increasing reliability.

The Low Level Warning System indicates that solution level is 2.0 gallons or less. The warning system resets automatically when the user begins a 5 or 10 gallon mix.

Specifications

- 120 Volts AC
- Dimensions:
 - Standard Model – 30" H x 24" W x 12" D
 - Space Saver – 21" H x 24" W x 12" D
- Capacity:
 - Standard Model – 12.5 Gallons, Developer & Fixer
 - Space Saver – 7.5 Gallons, Developer & Fixer
- Operating Range: 18-125 p.s.i. Water Pressure

BROCHURE AVAILABLE

IS-199 Standard Configurations (other configurations available)

CAT. #	DESCRIPTION	CHEMISTRY TYPE	LIST
19945 19946-SS	Standard 12.5 Gal. Space Saver 7.5 Gal.	T ₂ Developer/T ₂ Fixer T ₂ Developer/T ₂ Fixer	\$890.00 890.00
19950 19951-SS	Standard 12.5 Gal. Space Saver 7.5 Gal.	Autex/Simon Dev. & Fix. Autex/Simon Dev. & Fix.	\$890.00 890.00
19952 19953-SS	Standard 12.5 Gal. Space Saver 7.5 Gal.	E.K. RP Dev./T ₂ Fix. E.K. RP Dev./T ₂ Fix.	\$890.00 890.00
19956 19957-SS	Standard 12.5 Gal. Space Saver 7.5 Gal.	E.K. RP Dev./RPLO Fix E.K. RP Dev./RPLO Fix	\$975.00 975.00
19960 19961-SS	Standard 12.5 Gal. Space Saver 7.5 Gal.	A.G. Dev./A.G. Fix. A.G. Dev./A.G. Fix.	\$975.00 975.00
19966 19967-SS	Non Standard 12.5 Gal. Space Saver 7.5 Gal.	Must specify requirements	\$975.00 975.00

WMI can provide mixers for use with most chemistry. Many are not listed above. Please call for more information.



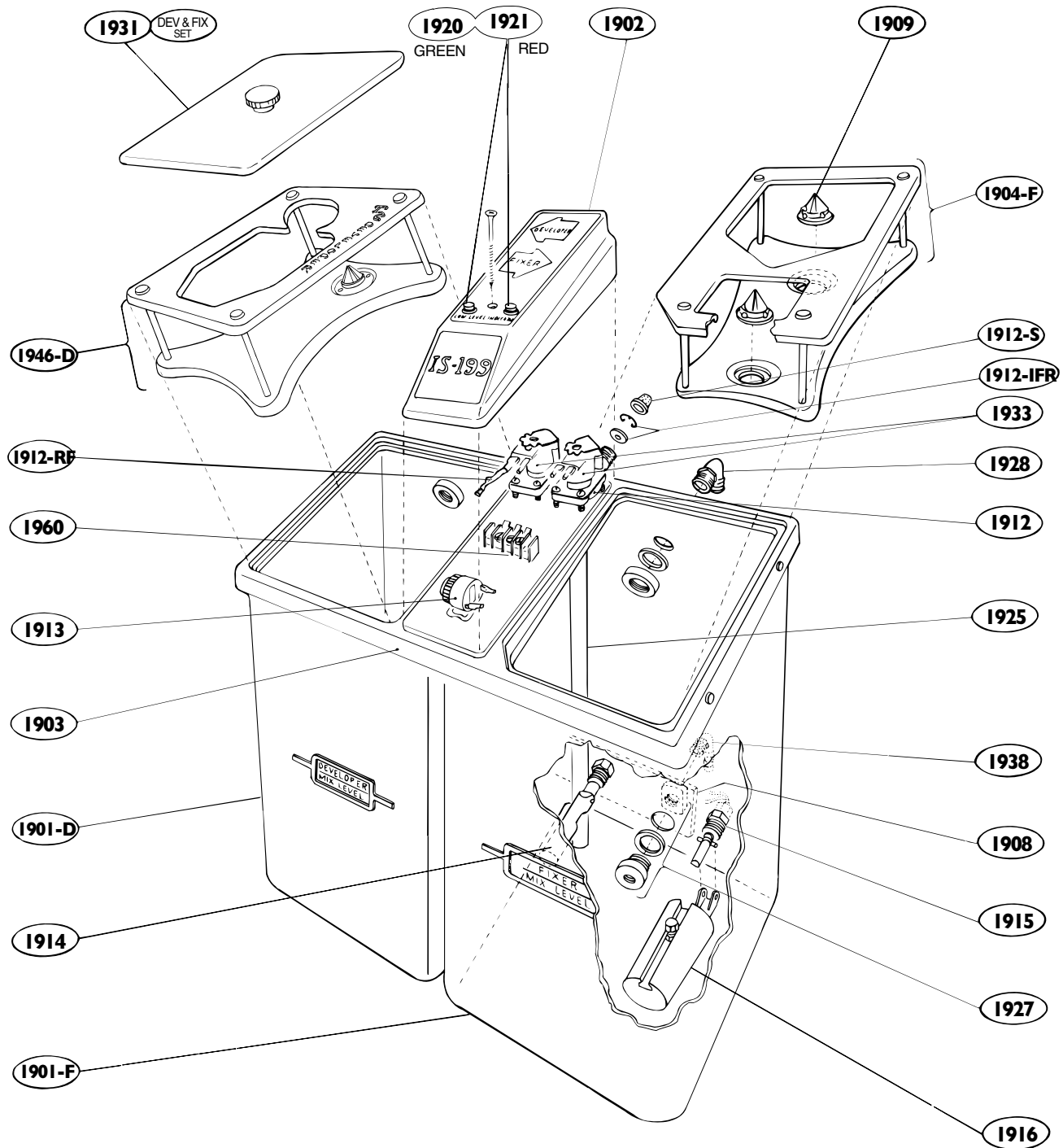

IS-199 Chemical Mixer Replacement Parts

PART NO.	DESCRIPTION	LIST PRICE
1901-D	Tank, P/E – Developer.....	\$72.00
1901-F	Tank, P/E – Fixer.....	72.00
1902	Component Cover	22.50
1903	Top Assembly	60.00
* 1904-D	Developer Template/Knife Assembly, Autex/Simon	150.00
* 1904-F	Fixer Template/Knife Assy., T2 Fixer, HR Simon Fix, Autex Fix	48.00
* 1906-D	Developer Template/Knife Assembly, Kodak, RP X-omat	150.00
* 1906-DEX2	Developer Template/Knife Assembly, Kodak, DEX2	150.00
* 1906-F	Fixer Template/Knife Assembly, Kodak.....	150.00
* 1907-D	Developer Template/Knife Assembly, Agfa Medical	150.00
* 1907-F	Fixer Template/Knife Assembly, Agfa	150.00
1908	Retention Strap	9.00
1909	Knife – 38mm	3.50
1910	Knife – 28mm (special, <i>not shown</i>).....	4.50
1911	Transformer (<i>not shown</i>)	37.50
1911-EX	External Transformer (<i>not shown</i>)	45.00
1912	Valve – Solenoid 24 Volt w/Internal Flow Restrictor.....	52.45
1912-IFR	Internal Flow Restrictor & Retaining Ring.....	8.65
1912-RF	Resettable Fuse	6.00
1912-S	Inlet Screen for Catalogue #1912	1.15
1913	Audible Alarm	42.35
1914	Switch, Low Level.....	37.50
1915	Switch, Specific Gravity.....	42.35
1916	Float, S.G. Adjustable.....	48.00
1918	Wiring Harness (<i>not shown</i>).....	15.00
1919	Power Cord (<i>not shown</i>).....	6.00
1920	Lamp – 24 Volt Green	6.00
1921	Lamp – 24 Volt Red.....	6.00
1922	Lamp – 24 Volt Blue (<i>not shown</i>)	6.00
1925	Water Inlet Pipe.....	4.50
1927	Replenisher Bulkhead, 3/8"	12.00
1928	Elbow – Overflow 1" w/Washer and Nut	6.75
1929	Hi-Pressure Y-Hose (<i>not shown</i>)	14.95
1931	Template Cover Set.....	25.00
1933	Solenoid Coil (only)	11.25
1935	Stanchion, Clips, SS Hex Nut (<i>not shown</i>).....	1.50
1938	3/8" NPT x 3/8" Hose, 90° Adapter	1.00
* 1944-D	Developer Template/Knife Assembly, WMI Cine.....	48.00
* 1946-D	Developer-Template/Knife Assembly, T2 Developer Unipack....	48.00
1960	Terminal Strip	6.00

***WMI can provide templates for most chemistry and mixer combinations.
Many are not listed above. Please call for more information.**



Chemical Mixer Conversion Kits

CAT. #	DESCRIPTION	LIST PRICE
#3587	T ₂ Developer Template Assy. for Autex Mixer	\$48.00
#3584-D2	T ₂ Developer Template for Simon Mixer	48.00
#3595	T ₂ Developer Template for Thatcher Mixer	48.00

T₂ Developer Activator Developer Activity Booster

According to information we have gathered from field personnel, most mammography film processors experience a fall off in activity when the developer is changed. Typically, this can be as much as a 0.10 – 0.20 reduction in Speed along with a corresponding reduction in Contrast and Average Gradient. In order to lessen the sensitometric variations and restore the developer to normal activity levels, we have formulated T₂ Developer Activator, an activity booster for the T₂ Developers, designed to increase the activity level of fresh developer to equal the activity of seasoned developer. Assists in maintaining T₂ Developer Activator QA-sensitometry control at developer change-out.

- Specifically formulated to increase speed and contrast on mammography films
- Convenient 6 x 1 quart packaging.

Catalogue # 4900A

List Price: \$58.45 per case



Catalogue #4900A

BROCHURE AVAILABLE

T₂ Developer Starter

- Neutral pH
- Can be used with all X-ray Developers
- Convenient 6 x 1 Quart Packaging

Catalogue #4900S

List Price: \$40.85 per case



Catalogue #4900S

ACCESSORY
CHEMICALS





Catalogue #4904SR

SR₂ Single-Part Rapid Developer Systems Cleaner

A single-part, easy to use developer rack, tank and replenishment system cleaner concentrate. This proprietary formulation is environmentally safe and it is chromate free. Dilution is flexible meaning one can estimate a 1 plus 4 to a 1 plus 9 dilution with effective cleaning results.

* Subject to \$20.00 Hazardous Fee per case

- Contains No Dichromates
- Environmentally Safe
- Single (one)-part
- Dilution up to 1+9
- Fast Acting Formula
- Convenient 6 x 1 Quart packaging

Catalogue # 4904SR

List Price: \$51.85 per case



Catalogue #4902EC

T₂ ESC Developer Cleaner

A safe alternative to dichromate-based cleaners. This Developer Cleaner provides effective cleaning of developer racks, tanks and recirculation systems.

- Environmentally Safe
- Contains No Dichromates
- 2 x 32 oz. Part 1
- 2 x 32 oz. Part 2
- 2 x 32 oz. Neutralizer

Catalogue #4902EC

List Price: \$24.85 per case

BROCHURE AVAILABLE



Catalogue #4900FC

T₂ Fixer System Cleaner

- Fast Acting Formula
- Cleans: Rack, Recirculation System, Overflow Weir and Drain
- Convenient 6 x 1 Quart Packaging

Catalogue #4900FC

List Price: \$29.75 per case



To Order

Phone: (603) 648-2124
Monday - Friday 8:30 am - 5:00 pm EST

FAX: (603) 648-2197

E-Mail: wmi@wmi-T2.com

Web Site: www.wmi-T2.com

Mail: White Mountain Imaging
PO Box 216
Salisbury, NH 03268-0216

Terms of Sale

Terms: **United States and Canada**

- Less 2.5% Net 10 Days From Invoice Date
- Net 30 Days
- MC, VISA and AMX accepted

Freight: All Orders Are Shipped Freight Prepaid
Shipping and Handling Charges are \$10.95 per order on catalogue items.

International

- \$100 Minimum Order
- Cash with Order
- 2.5% CWO Discount with Order
- Freight Collect
- MC, VISA and AMX accepted

Return Policy:

White Mountain makes every effort to make equitable arrangements with our customers who wish to return goods for credit. While some goods such as special order items, or chemical orders which have been in your warehouse for more than 90 days may not be eligible for return, most items can be returned subject only to a small restocking charge, provided you (our dealer) pay the return freight. In order for a return to be eligible for credit you must call White Mountain and obtain a Return Authorization (RA) number.

For Information:

We are happy to provide more information on any of the products we sell. We can also provide sales brochures for many of the products listed in this Catalogue.

Your comments and ideas are important to us. Let us know if there are other products you would like to see us carry.

We make every attempt to hold our pricing from one Catalogue to the next. Should adjustments be necessary before the printing of the next Catalogue, we will inform you of any changes when you place your order.

Material Safety Data Sheets for all of our products can be found on our website

ORDERING
INFORMATION



CAT. #	DESCRIPTION	PAGE #
1923	IS-199 Spill Tray	19
1924	IS-199 Floating Lid	19
199_ _	IS-199 Chemical Mixers	19-22
3504	Photobrome™ Feeder.....	15
3504-B	Photobrome™ Feeder Basket	15
3505	Photobrome™ Feeder O-Ring.....	15
3506	Photobrome™ Feeder Cap.....	15
3507	Photobrome™ Tablets	15
3508	Photobrome™ Tablets/case	15
3509	Photobrome™ Lab Pak II	15
3510	Photobrome™ Lab Pak II/case	15
3511	Neutra•Sol™ Processor Drain Cleaner.....	13
3512	Scotch-Brite® Cleaning Pads.....	16
3513	Scotch-Brite® Cleaning Pads/case.....	16
3515	Fotex Drain Cleaner.....	14
3516	250ml Graduated Cylinder	4
3516-P	Plastic Cylinder	4
3517-P	Portable S.G. Test Kit.....	2
3518	Hydrometer 1.00-1.200	4
3519	Silver Test Paper	3
3520	T2 Dev Temp/EK Automixer I.....	23
3522	T2 Repack Fix Temp/EK Automixer I.....	23
3524	pH Test Papers (Developer)	4
3525	pH Test Papers (Fixer)	4
3529-UF	Ultra Fine Cleaning Pads/box.....	16
3530-UF	Ultra Fine Cleaning Pads/case.....	16
3532-SP	3M Scotch-Brite® Scrubbing Sponges.....	16
3551	Silvermax Splicing Tape (1").....	17
3553	Silvermax Tape Dispenser	17
3555	DFP-450 Thermometer	3
3558	TM-99A Digital Thermometer	3
3558-CAL	TM-99A Calibration Plug.....	3
3558-P	TM-99A Probe	3
3559	Gorman-Rupp Pocket Bellows Pump.....	7
3560	Gorman-Rupp Replenisher Pump (240v)	7
3560-115	Gorman-Rupp Replenisher Pump (115v)	7
3560-M7-115	Gorman-Rupp Repl. Pump M7-B (115v).....	7
3561	March 802 Recirculation/Replenisher Pump	8
3561-RA 5000	March 802 RA 5000 Recirc./Replenisher Pump	8
3561-115	March 802 Recirculation Pump	8
3562	March MDX3 Recirculation Pump.....	8
3564	WMI Hypo Estimator Test Kit.....	2
3564-CHT	WMI Hypo Estimator Color Chart	2
3564-SOL	WMI Hypo Estimator Test Solution.....	2
3570	Developer Filter.....	5

CAT. #	DESCRIPTION	PAGE #
3571	Hot/Cold Water Filter (20-30µ)	6
3572	Hot/Cold Water Filter (5-10µ)	6
3573	12" Water Filter (20-30µ)	6
3574	"SlimLine" Developer Filter.....	5
3575	Konica Developer Filters	5
3579	Clear Water Filter Housing	6
3579-O	Replacement O-Ring (Water Filter Housing).....	6
3579-W	Filter Housing Wrench	6
3580	Mounting Bracket (Water Filter Housing)	6
3581-D	Repack EK Dev Temp/EK Automixer II	22
3581-F	T2 Repack Fix Temp/EK Automixer II.....	22
3583	T2 Dev Temp/EK Automixer II.....	22
3587	T2 Dev Temp/Autex Mixer	22
3600	Tandem 200®	9
3601	Tandem 200® Replacement Cells	9
3605	Tandem 100™	9
3606	Tandem 100™ Replacement Cells	9
3607	Act I™	9
3611	Silver Trap Disposable Window	10
3611-R	Replacement Cell Silver Trap	10
3612	Silver Trap Disposable Window	10
3612-R	Replacement Cell Silver Trap	10
3613	Silver Trap Wall Mount Bracket.....	10
3615	Silver Trap Window Wrench	10
3618	Final Phase Treatment System.....	12
3620	EPAN Chamber (3.5 Gal.)	12
3621	EPAN Chamber (6.5 Gal.)	12
3630-3	Phase One Fixer Treat. Cart. (3 Gal.).....	11
3630-5	Phase One Fixer Treat. Cart. (5 Gal.).....	11
3641	Spill Control Response Kit.....	18
3642	Spill Bloc™ Spill Response Polymer Kit	18
3642-R	Spill Response Replacement Polymer	18
3651	32 oz. Adzorbstar® Unit w/Bracket.....	17
3652	16 oz. Adzorbstar® Unit w/Bracket.....	17
3653	32 oz. Adzorbstar® Refill Canister	17
3654	16 oz. Adzorbstar® Refill Canister	17
3684	Clear Image Cleaning Solution/32oz.	14
3685	Clear Image Cleaning Solution/case.....	14
4900A	T2 Developer Activator.....	23
4900FC	T2 Fixer System Cleaner	24
4900S	T2 Developer Starter	23
4902EC	T2 ESC Developer Cleaner	24
4904SR	SR2 Developer Systems Cleaner	24
WM-RC1417	Rollerclean/box	4
WM-SCLR500	Kyokko Screen Cleaner/case.....	4



WHITE MOUNTAIN IMAGING FAX ORDER FORM (603) 648-2197

Customer # _____ P.O. # _____

Bill To: _____

Order Placed By: _____

Special Instructions: _____

Date of Order: _____

Ship To: _____

P.O. # _____

Telephone # _____

QUALITY CONTROL SUPPLIES PAGES 2-5

WM-RC1417	Rollerclean (50-14"x17" sheets per box)
WM-SCLR500	Kyokko Screen Cleaner Case (4x470ml)
3516	250 ml Clear Glass Cylinder
3516-P	Plastic Cylinder
3517-P	Portable S.G. Test Kit
3518	12" Hydrometer, SG 1.00-1.200
3519	Silver Test Paper
3524	Developer pH Test Paper
3525	Fixer pH Test Paper
3555	DFP-300 Thermometer
3558	TM-99A Digital Thermometer
3558-P	Probe for TM-99A Digital Thermometer
3558-CAL	Calibration Plug for TM-99A Digital Therm.
3564	WMI Hypo Estimator Test Kit
3564-CHT	WMI Hypo Estimator Color Chart

PROCESSOR FILTERS PAGES 6-7

3570	Developer Filter, 70µ, 2 1/2" x 4 7/8"
3571	Hot/Cold Water Filter, 20-30µ, 2 1/2" x 9 7/8"
3572	Hot/Cold Water Filter, 5-10µ, 2 1/2" x 9 7/8"
3574	"SlimLine" Polypropylene Developer Filter, 70µ
3575	Konica Filter, 70µ

PROCESSOR MAINTENANCE SUPPLIES PAGES 8-9

3559	Gorman Rupp Pocket Bellows Pump, 240V
3560	Gorman Rupp Repl. Pump, 240V
3560-115	Gorman Rupp Repl. Pump, 115V
3560-M7-115	Gorman Rupp Repl. Pump for M7-B, 115V
3561	March Recirculation/Repl. Pump, 230V
3561-RA 5000	March 802 RA5000 Recirculation Pump
3561-115	March 802 Recirculation Pump, 115V
3562	March MDX3 Recirculation Pump, 115V
3579	Clear Water Filter Housing
3579-O	Replacement O-Ring / Water Filter Housing
3579-W	Filter Wrench for Water Filter Housing
3580	Mounting Bracket for Water Filter Housing

POLLUTION ABATEMENT DEVICES PAGES 10-14

3600	Tandem 200 [®] Silver Recovery System
3601	Replacement Cells for 3600/3607 (2 ea.)
3605	Tandem 100 [™] Silver Recovery System
3606	Replacement Cells for 3605 (2 ea.)
3607	Act I [™] Silver Recovery Unit
3618	Final Phase Treatment System
3620	EPAN Chamber, 3.5 Gal.
3621	EPAN Chamber, 6.5 Gal.
3625	EPAN Installation Kit
3611	Silver Trap Disposable Window
3611-R	Replacement Cell Silver Trap
3612	Silver Trap Disposable Compact Window
3612-R	Replacement Cell Compact Window
3613	Silver Trap Wall Bracket
3630-3	Phase One Fix Treatment Cartridge, 3 Gal.
3630-5	Phase One Fix Treatment Cartridge, 5 Gal.

**Please photocopy this page before filling out your order.
Save the forms in this Catalogue for future orders.**

Brochures can be ordered by calling customer service at 603-648-2124 or you can fax your request to 603-648-2197.

Most MSDS for products manufactured by WMI are available and can be downloaded from our website www.wmi-t2.com



WHITE MOUNTAIN IMAGING

P.O. BOX 216 • SALISBURY, NH 03268-0216 • (603) 648-2124

WHITE MOUNTAIN IMAGING FAX ORDER FORM (603) 648-2197

Customer # _____ P.O. # _____

Bill To: _____

Order Placed By: _____

Special Instructions: _____

Date of Order: _____

Ship To: _____

PO. # _____

Telephone # _____

CLEANING SUPPLIES PAGES 15-18

3504	Photobrome™ Feeder
3504-B	Photobrome™ Feeder Basket
3504-SS	Screen Sock
3505	Photobrome™ Feeder O-Ring
3506	Photobrome™ Feeder Cap
3507	Photobrome™ Tablets, 4 lbs.
3508	Photobrome™ Tablets, Case (8 x 4 lb. box)
3509	Photobrome™ Lab Pak II, Box (6 paks)
3510	Photobrome™ Lab Pak II, Case (8 boxes)
3511	Neutra•Sol™ Processor Drain Cleaner
3512	Scotch-Brite® Cleaning Pads (20 sheets/box)
3513	Scotch-Brite® Cleaning Pads, Case (3 boxes)
3515	Fotex Drain Cleaner Case (36 packets)
3684	Clear Image (32 oz.)
3685	Clear Image, Case (12 x 32 oz.)
3686	Clear Image (4 x 1 gallon)
3529-UF	Ultra Fine Cleaning Pads, Box
3530-UF	Ultra Fine Cleaning Pads, Case
3532-SP	Scotch-Brite® Scrubbing Sponges, Case

DARKROOM SUPPLIES PAGES 19-21

3520	T ₂ Dev Template / EK Automixer I
3522	T ₂ / Repack Fix Template / EK Automixer I
3551	Silvermax Splicing Tape, 1" W, 72 yds/Roll
3553	Silvermax Tape Dispenser, 1/2" or 1"
3587	T ₂ Dev Template Assy. / Autex Mixer
3641	Spill Control Response Kit
3642	Spill Bloc™ Spill Response Polymer Kit

DARKROOM SUPPLIES (cont.) PAGES 19-21

3642-R	Spill Response Replacement Polymer
3651	32 oz. Adzorstar® Unit w/Bracket
3652	16 oz. Adzorstar® Unit w/Bracket
3653	32 oz. Adzorstar® Refill Canister
3654	16 oz. Adzorstar® Refill Canister

IS-199 CHEMICAL MIXERS PAGES 22-26

1923	Spill Tray
1924	Floating Lid
19945	Standard 12.5 Gal. T ₂ Dev/T ₂ Fix
19946-SS	Space Saver 7.5 Gal. T ₂ Dev/T ₂ Fix
19948	Standard 12.5 Gal. WMI Cine Dev & Fix
19949-SS	Space Saver 7.5 Gal. WMI Cine Dev & Fix
19950	Standard 12.5 Gal. Autex/Simon-Dev/Fix
19951-SS	Space Saver 7.5 Gal. Autex/Simon-Dev/Fix
19952	Standard 12.5 Gal. E.K. Dev./T ₂ Fix
19953-SS	Space Saver 7.5 Gal. E.K. Dev./T ₂ Fix
19956	Standard 12.5 Gal. EK Dev/EK Fix (EK packaging)
19957-SS	Space Saver 7.5 Gal. EK Dev/EK Fix (EK packaging)
19960	Standard 12.5 Gal. AG Dev/AG Fix
19961-SS	Space Saver 7.5 Gal. AG Dev/AG Fix

ACCESSORY CHEMICALS PAGES 26-27

4900A	T ₂ Developer Activator (6 x 1 qt.)
4900FC	T ₂ Fixer System Cleaner (6 x 1 qt.)
4900S	T ₂ Developer Starter (6 x 1 qt.)
4902EC	T ₂ ESC Developer System Cleaner
4904SR	SR ₂ Developer Systems Cleaner

Save the forms in this Catalogue for future orders.



WHITE MOUNTAIN IMAGING

P.O. BOX 216 • SALISBURY, NH 03268-0216 • (603) 648-2124



PO Box 216
Salisbury NH 03268
(603) 648-2124
Fax (603) 648-2197
www.wmi-t2.com